

Design Attributes

Wafer Dual Plate Check Valves use two half-sphere discs and a connecting hinge to create a closure element that collapses when positive flow exists, and folds back to a full circular disc when reverse flow exists. Discs are preloaded with springs that favour the closing of the valve when no positive flow. These valves are featured as a light, compact and economic option. With a dedicate design and production, they offer a low pressure drop in comparison to other wafer check valves, and full seat tightness, being widely used mainly in clean water and oil systems, with significant savings in space and investment costs for installation.



Main Features

Valve design: API 594
Nominal Pressure: 150#
Face to face length: API 594
Valve end connections: Wafer design to suit ASME B16.5 / B16.47 RF
Marking: MSS SP-55
Pressure Tests: API 598
Primer painted for protection during storage and transport
Product compliant with Directive 2014/68/EU on Pressure Equipment (PED) for European Union territory

Main Duties / Limits of use

Fluids compatible with materials of construction. Questions referring to chemical resistance, please consult us
Pressure / Temperature Rating to ASME B16.34
For products compliant with Directive 2014/68/EU, observe also limits acc. to Annex II tables 6 & 8 (gases & liquids group 1*) and tables 7 & 9 (gases & liquids group 2*) up to category III
*Classification of fluids (group 1 or 2) acc. to Directive 2014/68/EU, Article 13

Options

Other designs and materials. Please consult us

Main Parts and Materials

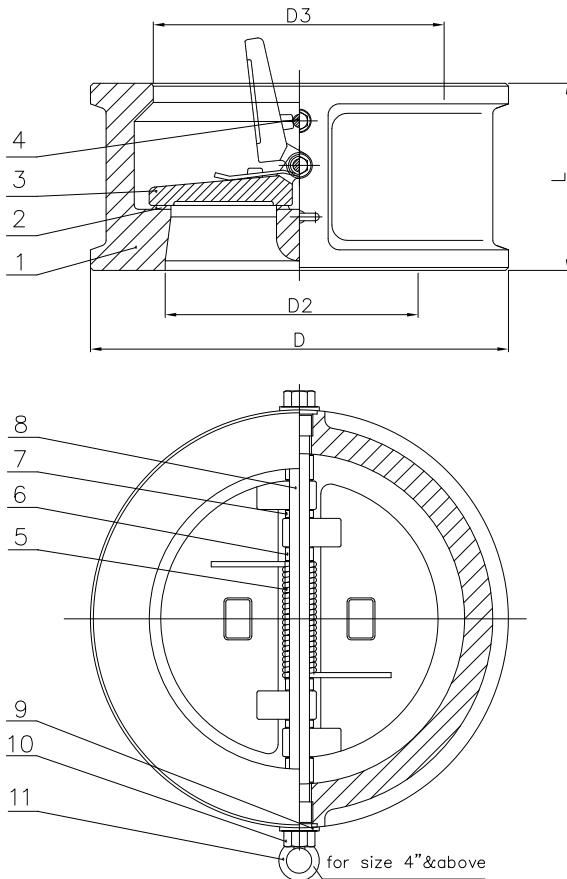

Nº	PART	MATERIAL			
1	BODY	A216 WCB	A351 CF8M	1.4469	C93200
2	SEALING FACE	13CR overlay			A351 CF8
3	DISC	A216 WCB	CF8M	1.4469	C93200
4	STOP PIN	A182 F304			
5	SPRING	SS304	SS316	X-750	
6	BEARING WASHER	SS304	Viton	Viton	EPDM
7	BEARING WASHER	SS304	Viton	Viton	EPDM
8	HINGE PIN	A182 F304	F316	254SMO	A182 F6
9	GASKET	SS304			
10	POSITION PLUG	Carbon steel			
11	EYEBOLT	Carbon steel			

Main Valve Parameters

DN	mm inch	50 2	65 2½	80 3	100 4	125 5	150 6	200 8	250 10	300 12	350 14
D		103	122	135	173	195	220	277	337	407	448
D2		51	65	80	102	127	152	203	254	305	350
D3		56	73	88	108	132	160	210	266	310	355
L		60	67	73	76	86	98	127	146	181	184

Dimensions in mm subject to manufacturing tolerance

DN	mm inch	400 16	450 18	500 20	600 24	700 28	750 30	800 32	900 36	1050 42	1200 48
D		512	547	604	715	773	824	878	983	1142	1302
D2		400	450	500	600	700	746	796	898	1050	1200
D3		405	455	505	605	700	750	800	910	1055	1205
L		191	203	219	222	305	305	305	368	432	524

Dimensions in mm subject to manufacturing tolerance